

Tarraco C PIR

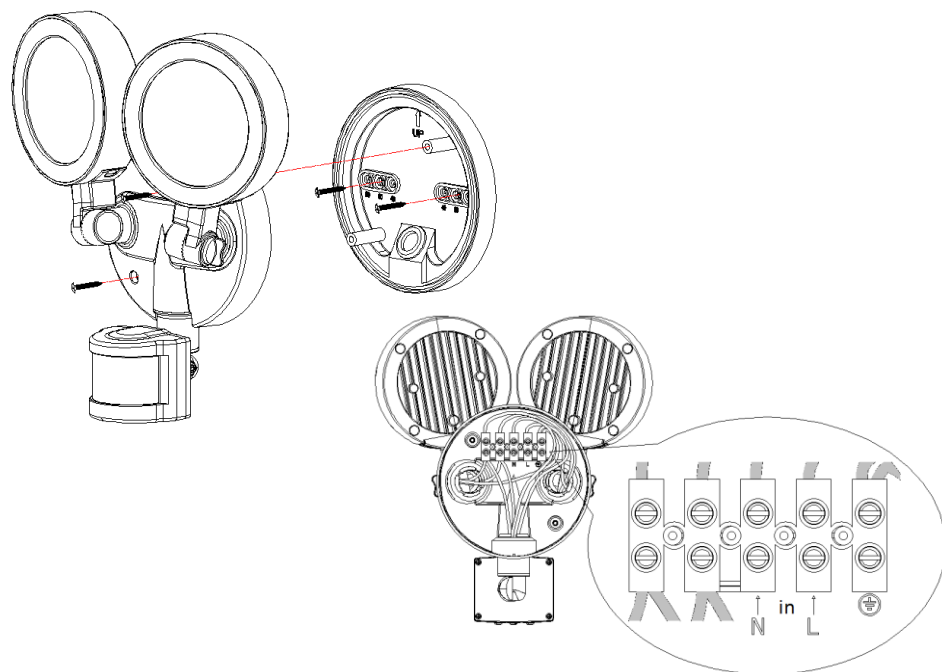
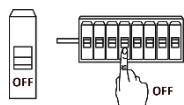
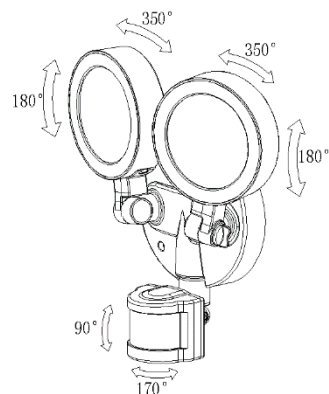

SPECIFICATION:

220-240V/AC, 50/60Hz

20W (1900LM), 4000K

IP65

Working Temperature: -20~+40°C

Detection Range: 180°, max.12m(<24°C), Detection Moving Speed: 0.6-1.5m/s

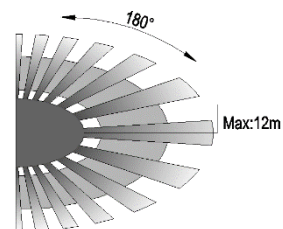

Installation Height: 1.8-2.5m

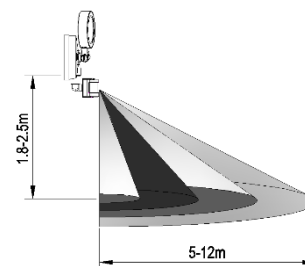

Detection distance: 5-12m

Ambient Light: <3-2000LUX(adjustable)

Time: Min.10sec±3sec, Max.5min±1min

